



SMOKE 'N' SOUND ACOUSTICAL SPRAY

APPLICATIONS

SMOKE CONTROL: Where stopping the passage of smoke is necessary such as in smoke barrier walls.

NOISE CONTROL: Where reducing the transmission of sound through wall openings is necessary to help ensure occupant privacy and peaceful environment.

INFECTIOUS/DUST CONTROL: Where reducing the transmission of dust and other airborne particulates through wall openings is necessary.

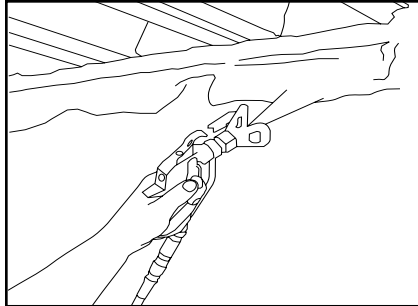

PRODUCT DESCRIPTION

SpecSeal® Smoke 'N' Sound Spray is a high quality acrylic latex spray designed for static or minimally dynamic linear joints or gaps in smoke rated barriers.

SpecSeal® Smoke 'N' Sound Spray is formulated to adhere to all common construction surfaces and may be applied using airless spray equipment or with a brush (for small applications and touch ups).

SpecSeal® Smoke 'N' Sound Spray dries to form a flexible shield against particulate air and smoke. Its premium latex binder system is totally resistant to water and will not re-emulsify after drying. SpecSeal Smoke 'N' Sound Spray contains no inorganic fibers, asbestos, or solvents.

FEATURE	BENEFIT
• Economical	High performance without the high price!
• Water Resistant	Will not re-emulsify when dry.
• Water-Based	Easy installation, cleanup, and disposal.
• Safe	No solvents! No asbestos!
• Thixotropic	Offers high build application.
• Acoustically Tested	Reduces noise transmission.
• Low Abrasion	Longer pump life and less maintenance.
• Low VOCs	Safe, No solvents, Non-Halogenated

PERFORMANCE

When applied to a wet film thickness of 1/8" (3.2 mm) to 1/4" (6 mm) over appropriate backing materials, SpecSeal® Smoke 'N' Sound Spray provides an L Rating of Less Than 1 CFM/Lin Ft at ambient and elevated temperatures to minimize the transmission of particulate air and smoke.

LIMITATIONS: Use product as per manufacturer's instructions. Use only in applications per the manufacturer's published designs or specific recommendations. End user must ultimately determine the suitability of the product and/or design to his or her specific requirements and assumes responsibility for its use. **PRODUCT CONTAINS WATER AND IS CONDUCTIVE UNTIL DRY. DO NOT APPLY IN THE PRESENCE OF EXPOSED OR ENERGIZED ELECTRICAL CONDUCTORS.**

PHYSICAL PROPERTIES

Properties	Smoke 'n' Sound Spray
Color	White
Odor	Mild Latex
Specific Gravity	1.25
Solids Content	77%
Flame Spread (ASTM E84/UL723)	0
Smoke Developed (ASTM E84/UL723)	0
Movement/Elongation	±8%
Coverage	12.8 sq ft/gallon @ 1/8"
Viscosity	(0.31 m ² L @ 3.2 mm) 150,000 – 200,000 cps

Properties	Smoke 'n' Sound Spray
pH	7-8
Solvent Content	NA
In Service Temperature	≤120° F (49°C)
Storage Temperature	40-95° F (4-35°C)
Application Temperature	60-90° F (16-32°C)
Dry Time	
Tack Free	*2 Hrs
Dry Through	*24 to 48 Hrs
STC Rating (ASTM E90/ASTM C919)	61
VOC Content (EPA Method 24/ASTM D3960)	0.29 lb/gal. (34 g/L)
Shelf Life	12 Months

* Tack free and dry through time may be affected by weather conditions



SPECIFICATIONS

The smoke sealing spray shall be a water based, high quality latex coating and shall dry to a water resistant and flexible smoke barrier when dry. The coating shall be tested for smoke sealing, noise abatement (acoustical) properties and shall meet class A finish requirements when tested in accordance with ASTM E84 (UL723). The approved coating shall be SpecSeal® Smoke 'N' Sound Spray.

Specified Divisions

Division 7 – Section 07 90 00 – Joint Protection

Division 7 – Section 07 95 00 – Expansion Control

Division 9 – Section 09 20 00 – Plaster and Gypsum Board

Division 9 – Section 09 80 00 – Acoustic Treatment

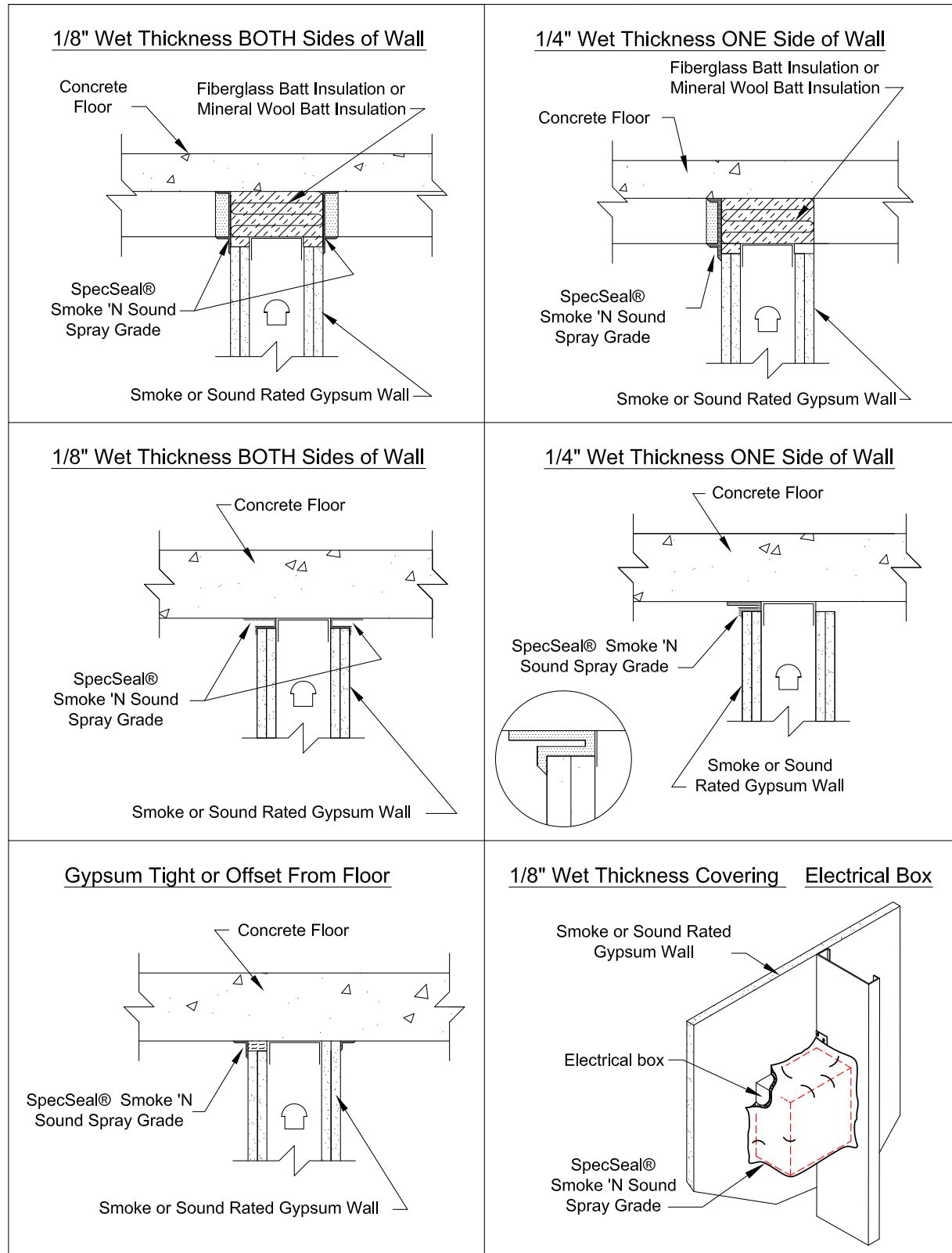

INSTALLATION INSTRUCTIONS

GENERAL: Areas to be sealed must be clean and free of frost, oil, loose dirt, rust or scale. Refer to PHYSICAL PROPERTIES for recommended storage and application temperatures. When applying coating at lower end of temperature range, warming the material to 70°F (21°C) will enhance drying characteristics. Drying time will vary according to prevailing temperature and humidity. Allow coating to thoroughly dry before exposure to moisture. Consult appropriate manufacturer's instructions. Forming or packing materials may be required as an integral part of various designs. Coating may be applied by airless sprayer up to 1/4" (6 mm) wet coating depth. If applying by brush or spraying on vertical surfaces where coating appears to be prone to slumping, multiple coats, or the application of a thin tack coat may be required. DO NOT ATTEMPT TO THIN PRODUCT BY ADDING WATER.

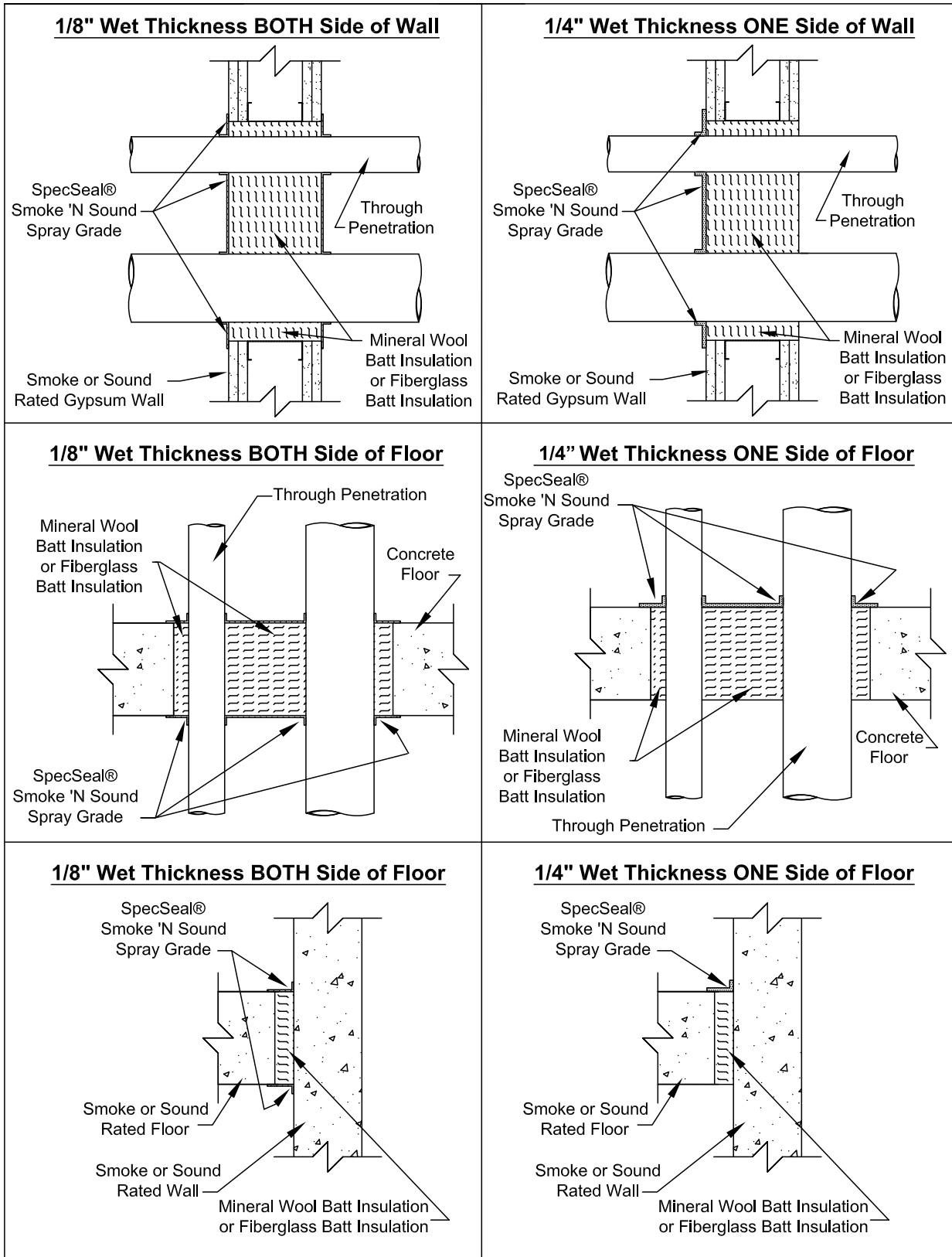

MAINTENANCE

Inspection: Installations should be inspected periodically for subsequent damage. Following safety precautions listed below and pertinent installation guidelines, remove coating in damaged areas down to undamaged material. Reapply fresh coating material to original coating thickness.

TECHNICAL SERVICE

Specified Technologies Inc. provides toll free technical support to assist in product selection and appropriate installation design. UL Systems, Material Safety Data Sheets and other technical information are available in the Technical Library at www.stifirestop.com.

PRECAUTIONARY INFORMATION

Consult Material Safety Data Sheet for additional information on the safe handling and disposal of this material. Wash areas of skin contact with soap and water. Avoid contact with eyes. The use of an OSHA or NIOSH approved mask for dust and mist environment is recommended. Apply in areas with adequate ventilation.

CAUTION: COATING IS CONDUCTIVE UNTIL DRY. DO NOT APPLY TO OR IN THE PRESENCE OF ENERGIZED ELECTRICAL CONDUCTORS.

AVAILABILITY

SpecSeal® Smoke 'N' Sound Spray is available from authorized distributors worldwide. Consult factory for names and locations of the nearest sales representatives or distributors.

Part #	Description	Packaging	Size
SNS205	Smoke 'n' Sound Acoustical Spray	Pail	5 Gallon (19.0 L)

IMPORTANT NOTICE: All statements, technical information, and recommendations contained herein are based upon testing believed to be reliable, but the accuracy and completeness thereof is not guaranteed.

WARRANTY

Specified Technologies Inc. manufactures its goods in a manner to be free of defects. Should any defect occur in its goods (within one year), Specified Technologies Inc., upon prompt notification, will at its option, exchange or repair the goods or refund the purchase price.

LIMITATIONS AND EXCLUSIONS:

THIS WARRANTY IS IN LIEU OF ALL OTHER REPRESENTATIONS EXPRESSED OR IMPLIED (INCLUDING THE IMPLIED WARRANTIES OF MERCHANTABILITY OR FITNESS FOR USE) AND UNDER NO CIRCUMSTANCES SHALL SPECIFIED TECHNOLOGIES INC. BE RESPONSIBLE FOR ANY INCIDENTAL OR CONSEQUENTIAL PROPERTY DAMAGE OR LOSSES. PRIOR TO USE, THE USER SHALL DETERMINE THE SUITABILITY OF THE PRODUCT FOR ITS INTENDED USE, AND THE USER ASSUMES ALL RISKS AND LIABILITY FOR SUBSEQUENT USE.

No statement or recommendation not contained herein shall have any force or effect unless in an agreement signed by officers of seller and manufacturer.

MADE IN THE USA – COPYRIGHT © 2008 SPECIFIED TECHNOLOGIES, INC.



Specified Technologies Inc. • 200 Evans Way, Somerville NJ 08876 • Phone: 800.992.1180 • Fax: 908.526.9623

